



Manual de instrucciones

A5E-A

Operation Manual

BEFORE OPERATION :

1. Never operate the machine unless its oil reservoir has been filled with oil.
2. After setting up the machine, check the direction of motor rotation. To check it, turn the hand wheel by hand to bring the needle down, and turn the power switch ON while observing the hand wheel. (The hand-wheel should turn counterclockwise as observed from the hand wheel side)
3. Confirm that the voltage and phase (single or 3-phase) are correct by checking them against the ratings shown on the electronic identification.

OPERATION PRECAUTIONS:

1. Keep your hands away from the needle when you turn the power switch ON or while the machine is operating.
2. Do not put your finger into the thread take-up-lever while the machine is operating.
3. Be sure to turn the power switch OFF before tilting the machine head.
4. When an operator leaves from the machine, make sure to turn off the power.
5. During operation, be careful not to allow your or any other person's head or hands to come close to the bobbin winder or hand wheel. Also, do not piece anything close to them. Doing so may be dangerous.
6. If your machine is provided with a finger guard or any other protectors, do not operate your machine with any of them removed.
7. Don't clean the face of machine head with thinner.

1. SPECIFICATIONS

Application	General fabrica, light-weight and mdeium-weight materials	Mdeium-weight materials, Heavy-weight materials
Sewing speed	Max. 4,000rpm	Max. 3,500rpm
Max.Stitch length	5mm	
Needle	DBx1 #9~#18 (14#)	DPx5 #20~#23 (#21)
Presser foot lift	9mm (standard) ;12mm	9mm (standard) ;12mm (Max.)
Lubricating oil	New Defrix Oil NO.10	

2. INSTALLATION

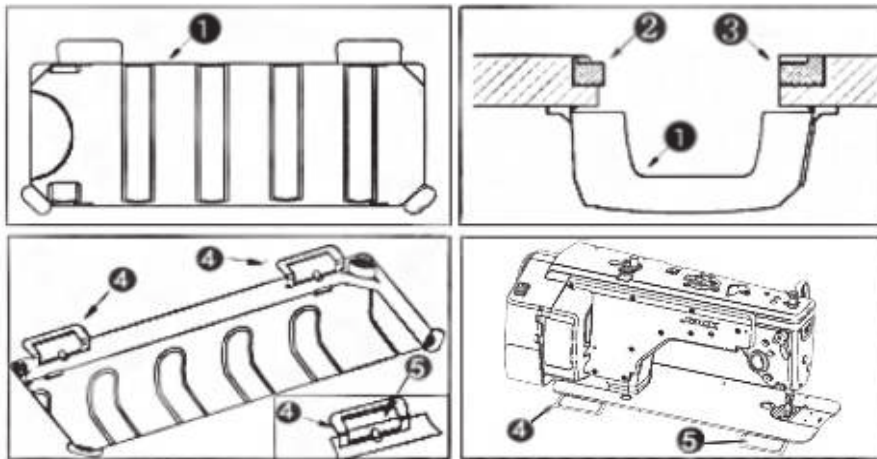

(1)The installation of plastic reservoir

- 1) Install the plastic reservoir ① under the stand & table.
- 2) Put the machine holder ③ and the machine cushion ② on the stand & table. As is shown in the chart, making sure that the two oil holders ③ are pointing to the operator during the installation and the two oil pan cushions ② are on the side which is with machine head connecting hook ⑤.
- 3) Install the machine head connecting hook base ④ on the stand & table, and then put the machine head connecting hook ⑤ in the baseplate hole, at last, put the head on the stand table, making sure machine head connecting hook ⑤ is nested in the machine head

3. ADJUSTING THE HEIGHT OF THE KNEE LIFTER

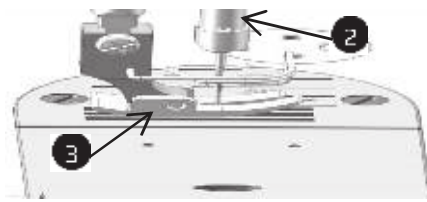

- 1) The standard height of the presser foot lifted using the knee lifter is 10mm.
- 2) You can adjust the presser foot lifted up to 13mm using knee lifter adjust screw ①.
- 3) When you have adjusted the presser foot lift to over 10mm, be sure that the bottom end of needle bar ② in its lowest position does not hit presser foot ③.

4. LUBRICATION

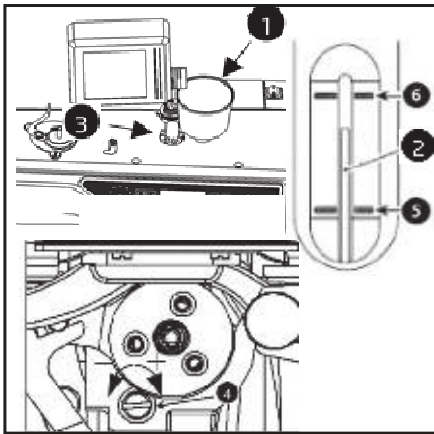

Before the machine operation, please inject 375mL New Defrix No.10 oil

- 1) Please keep the sewing machine open, take off the rubber plug on the upper arm, and use a funnel ① to add oil.
 - 2) Please observe and confirm the amount of oil added from the oil window ② of the machine. when the machine oil cannot ensure the normal operation of the machine, please add oil appropriately and pay attention to the lowest level ⑤ (red line) and highest level ⑥ (blue line). If the oil exceeds the highest level ⑥ (blue line), there may be oil leakage. Please pay attention.
 - 3) Running the machine after adding oil, if it's normal of lubrication, we can see the oil flow through the window ③.
 - 4) The oil quantity of rotating shuttle decreases when the oil quantity adjusting screw ④ is left-handed. The oil quantity of rotating shuttle increases when the oil quantity adjusting screw is turned right.
- ※ Note that the amount of the splashing oil is unrelated to the amount of the lubricating oil.
 - ※ The new machine should be replaced after 1 month, and the oil should be replaced every six months later.



When you first operate your machine after seter or after an extended period of disuse, run your machine at 2,500 to 3,000 rpm .for about 10 minutes for the purpose of break-in.

5. THREADING THE MACHINE HEAD

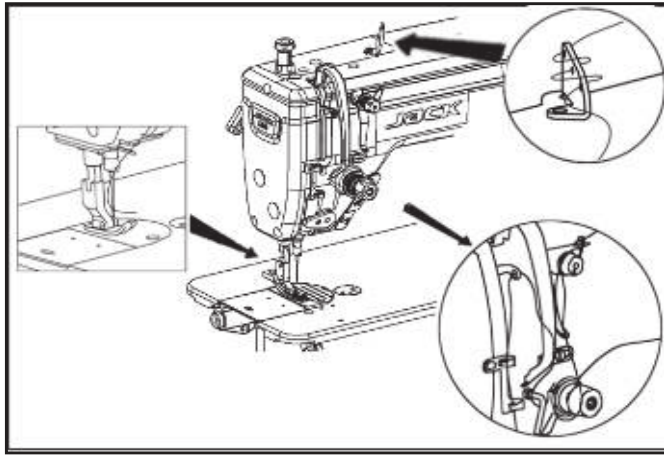

6. NEEDLE-TO-HOOK RELATIONSHIP

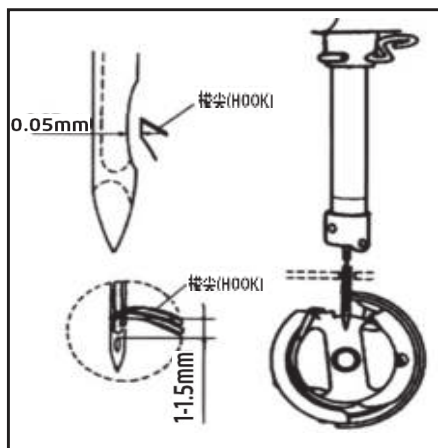

(1) Adjust the timing between the needle and the hook as follow:

1) Turn the hand wheel to bring the needle bar down to the lowest point of its stroke, and loosen setscrew.

* Adjusting the needle bar height

2) Pull the needle bar, you can see the pinhole basset 1/2 level through edge of inside hook (needle must be position). Turn needle cover wire slot left, then tighten setscrew.

* Adjusting position a of the hook

3) First move the point of hook in direction, when running strap pulley needle bar risen from the lowest, observe cooperate relation of the hook and needle. When hook point above Pinhole about top of 1mm to 1.5mm and when plane of the hook point form plane of needle short bar 0.05mm (keep the align hook blade point with the center of needle), tighten the hook setscrews.



*Precaution

If the clearance is too small, the tip of the hook will be abraded.

If it is too big, it will lead to skip over.

*Note that the type of hook to be substituted for, when replacing the hook, shall be in conformity with the very type of the hook installed in the sewing machine of original assemblage.

After replacing the needle, the needle must be same type and install right position. If the needle is different type need check match with relation.

7. THREAD TENSION

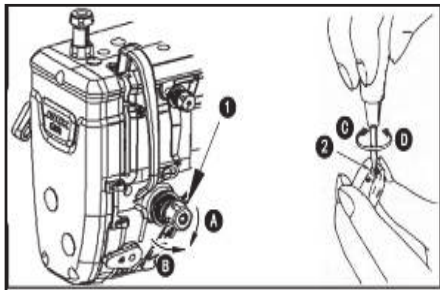

(1) Adjusting the needle thread tension

1) Adjust the needle thread tension using tension adjust nut ① according to the sewing specifications.

2) As you turn nut ① clockwise (in direction A), the needle thread tension will increase.

3) As you turn nut ① counterclockwise (in direction B), the tension will decrease.

(2) Adjusting the bobbin thread tension

1) As you turn tension adjust screw ② clockwise (in direction C), the bobbin thread tension will increase.

2) As you run screw ② counterclockwise (in direction D), the bobbin thread tension will decrease.

8. PEDAL PRESSURE AND PEDAL STROKE

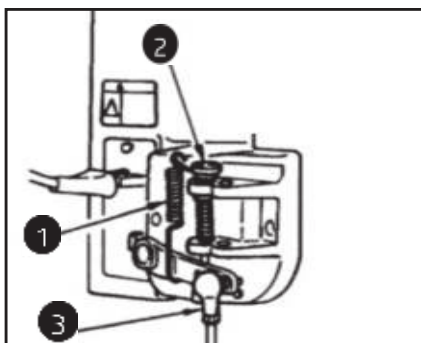

(1) Adjusting the pressure required to depress the front part of pedal

1) This pressure can be changed by changing the mounting position of pedaling pressure adjust spring ①.

2)The pressure decreases when you hook the spring on the left side.

3)The pressure increases when you hook the spring on the right side.

(2)Adjusting the pressure required to depress the back part of the pedal

1)This pressure can be adjusted using regulator screw ② .

2)The pressure increases as you turn the regulator screw in .

3) The pressure decreases as you turn the screw out.

(3)Adjusting the pedal stroke

1)The pedal stroke increases when you insert connecting rod ③ into the right hole

9. ADJUSTMENT OF THE PEDAL

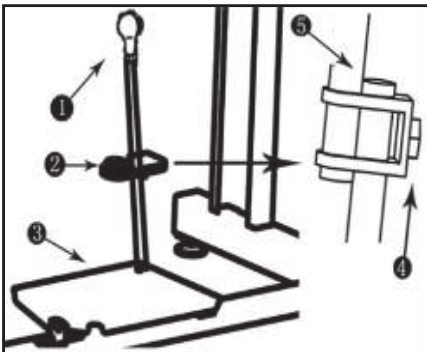

(1) Installing the connecting rod

1)Move pedal ③to the right or left as illustrated by the arrow so that spherical head ①and connecting rod ②are straightened.

(2) Adjusting the pedal angle

1)The pedal tilt can be freely adjusted by changing the length of the connecting rod.

2)Loosen adjust screw④,and adjust the length of connecting rod⑤.

10. ONE-TOUCH TYPE REVERSE FEED STITCHING MECHANISM

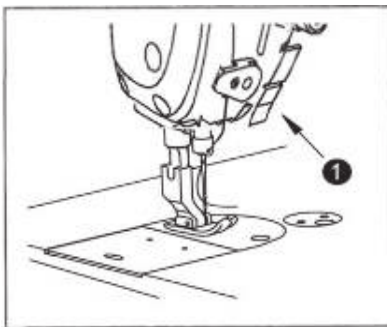

(1)How to operate

1)The moment switch button ① is pressed,the machine performs reverse feed stitching.

2)The machine performs reverse feed stitching as long as the switch lever is held depressed.

3)The machine resumes normal feed stitching the moment the switch lever is released.

11. THREAD TAKE UP SPRING

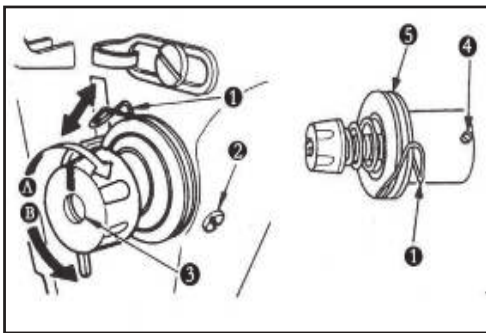

(1) Changing the stroke of thread take-up spring ①

1) Loosen setscrew ② .

2) As you turn tension post ③ clockwise (in direction A), the stroke of thread take-up spring will be increased.

3) As you turn the knob counterclockwise (in direction B), the stroke will be decreased.

(2) Changing the pressure of threads take-up spring ①

1) Loosen setscrew ② , and take out tension asm ⑤ .

2) Loosen setscrew ④ , and remove tension post ③ .

3) As you turn tension post ③ clockwise (in direction A), the pressure will be increased.

4) As you turn the post ③ counterclockwise (in direction B), the pressure will be decreased.

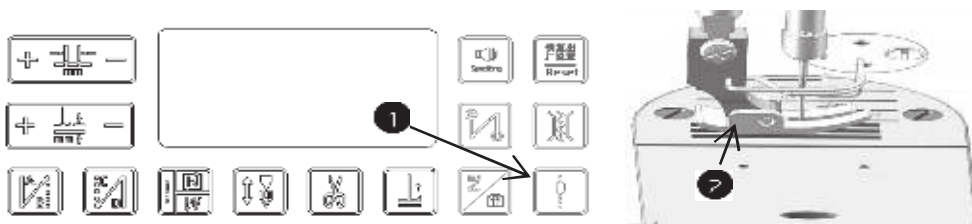

12. Less bird's nest



(1) After open the machine , press to ① achieve the function for the bird's nest of opening and closing.

(2) After the start sewing, the thrum of the clamp cannot be cut off many times in the process of sewing ,then you need to change the matched presser foot ② .

13 多国语言快捷切换/

Long press the voice button  and switch the parameter number by pressing  or  pressing. When switching parameters, prompt the corresponding language "language function is open". The interface parameters and language names are shown in the following table:

0	1	2	3	4
English	Spanish	Portuguese	Russian	Arabic
5	6	7	8	9
Vietnamese	Persian	Bengali	Turkish	Indonesian
10	11	12	13	
Polish	Italian	Thai	Ukrainian	

Notes for safe use of industrial sewing machines:

1. Basic measures must be observed.
2. Pass the specialized training and master sewing machine equipment performance.
3. All safety devices should be checked before use.
4. When installing needle, and changing needle, presser foot, plate, feed dog, bent needle, hook or repairing, the power supply should be turned off immediately.
5. Power should be turned off when leaving the sewing machine or workplace.
6. When using the clutch motor, please wait until the motor stops completely.
7. The machine oil and other liquids used in sewing machines and ancillary devices should be cleaned immediately when they are put into eyes or touch skin.
8. Do not touch the parts or devices when the machine is powered by hand.
9. The repair, renovation and adjustment of the main mechanisms of the relevant industrial sewing machines and overseers shall be carried out by specialized technicians.
10. General maintenance is carried out by specially-assigned persons.
11. Electrical repairs should be performed under the supervision and direction of the electrical technician.

Manual de instrucciones

Máquina de coser Jack

JACK SEWING MACHINE

HTTP://WWW.CHINAJACK.COM

Jacid de México

- Dirección de la empresa :
Paseo Tollocan #121 La Concepción, San Mateo Atenco, Méx.
Código Postal: 52105
- Departamento de Comercio Interno :
(TEL) : 728 285 4388
EXTENSIONES :
- www.jacid.com.mx
- www.jack.jacid.com.mx

